

Installation Instructions

S-5![®] Warning! Please use these products responsibly! Visit our website or contact your S-5! distributor for available load test results. The user and/or installer of these parts is responsible for all necessary engineering and design to ensure the S-5-U has been properly spaced and configured.

Notice to S-5! users: Due to the many variables involved with specific panel products, climates, snow melt phenomena and job particulars, the manufacturer cannot and does not express any opinions as to the suitability of any S-5! assembly for any specific application and assumes no liability with respect thereto. S-5! products are tested for ultimate holding strength on various profile types and materials. This information is available from the S-5! website: www.S-5.com. This document is an installation guide only and the photographs and drawings herein are for the purpose of illustrating installation tools and techniques, not system designs.

The S-5-U clamp is made for typical standing seam profiles. When attaching to machine folded seams (regardless of panel profile and geometry), S-5! clamps are designed to engage the seam as shown. For horizontal seam applications (illustrated in Step 4), the setscrew(s) must be accessible from the top for tightening.

Tools Needed

- Screw Gun
 - 3/16" Allen Bit Tip (provided)
 - Dial-Calibrated Torque Wrench*
- (*For accurate tension values, do NOT use a clicking torque wrench)

To Install S-5-U and S-5-U Mini

1. The S-5-U has four setscrew locations to make the clamp more versatile, however, only two setscrews are used per clamp. Both setscrews should always be loaded into the same side of the clamp. The S-5-U Mini has two setscrew locations, however only one setscrew is used per mini clamp. Partially thread the setscrew(s) into the clamp by hand.
2. Determine how to position the clamp. Setscrew(s) should be positioned opposite the seam fold as illustrated.
3. Tighten the setscrew(s) at the base of the clamp using a screw gun and the included screw gun bit tip. Standard clamps requiring two setscrews should be tensioned and re-tensioned as the seam material compresses, i.e. tighten the first setscrew, then the second; then repeat until each setscrew achieves the recommended torque. Screw tension should be verified using a calibrated torque wrench between 160 and 180 inch pounds when used on 22ga steel and between 130 and 150 inch pounds for all other metals and thinner gauges of steel.
4. Each clamp has two bolt holes to accommodate both vertical or horizontal seam applications. To attach heavy-duty applications using the standard S-5-U clamp, tighten the included M10 bolt to 20 foot pounds. To attach medium-duty applications using the S-5-U Mini clamp, tighten the included M8 bolt to 13 foot pounds.

S-5![®] Warning! Please use this product responsibly!

Products are protected by multiple U.S. and foreign patents. Visit the website at www.S-5.com for complete information on patents and trademarks. For maximum holding strength, setscrews should be tensioned and re-tensioned as the seam material compresses. Clamp setscrew tension should be verified using a calibrated torque wrench between 160 and 180 inch pounds when used on 22ga steel, and between 130 and 150 inch pounds for all other metals and thinner gauges of steel. Consult the S-5! website at www.S-5.com for published data regarding holding strength.

Copyright 2014, Metal Roof Innovations, Ltd. S-5! products are patent protected. S-5! aggressively protects its patents, trademarks, and copyrights. Version 050714.

These instructions are for use by those experienced in the trade. Always follow appropriate safety precautions and use appropriate tools.

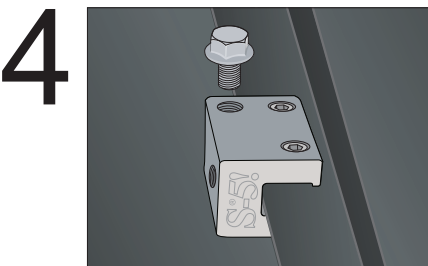
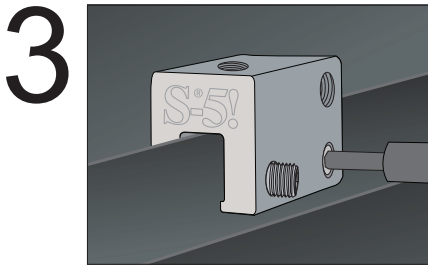
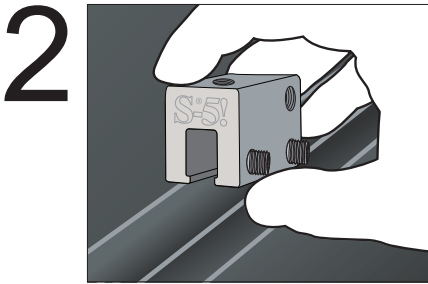
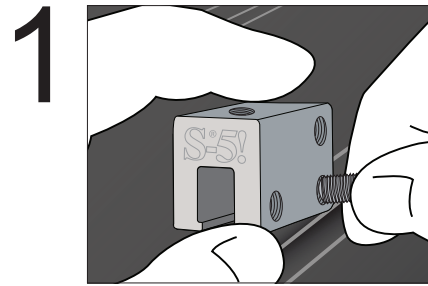

Above illustration shows horizontal seam application.

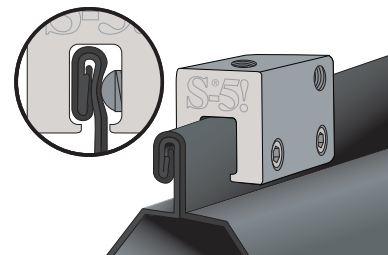

Above illustration shows proper setscrew positioning (opposite seam fold).